

887

WEST MARIETTA ST. NW  
ATLANTA, GA 30318

Premier 12,500 SF  
stand-alone Building

**FOR SALE**

within the King Plow  
complex in West Midtown

**CONTACT INFO:**

**BRIAN HOWELL**

BRIAN.HOWELL@BRIDGER-PROPERTIES.COM

404-234-5067



- Highly-desirable owner-occupier building in the heart of West Midtown.

- Investment Sale or Potential Re-development opportunity

# ABOUT WEST MIDTOWN

Known for its industrial-chic aesthetic, West Midtown boasts a mix of historic buildings, modern lofts, and repurposed warehouses. The neighborhood is characterized by its thriving arts and design community, with numerous galleries, boutiques, and studios showcasing the work of local artists and artisans. West Midtown is also home to some of Atlanta's top restaurants and has emerged as a hot spot in the city's culinary scene.

## BY THE NUMBERS

WALK SCORE  
**70**

MEDIAN AGE  
**27**

EDUCATIONAL ATTAINMENT  
**62%**

AVERAGE HH INCOME  
**\$92,643**

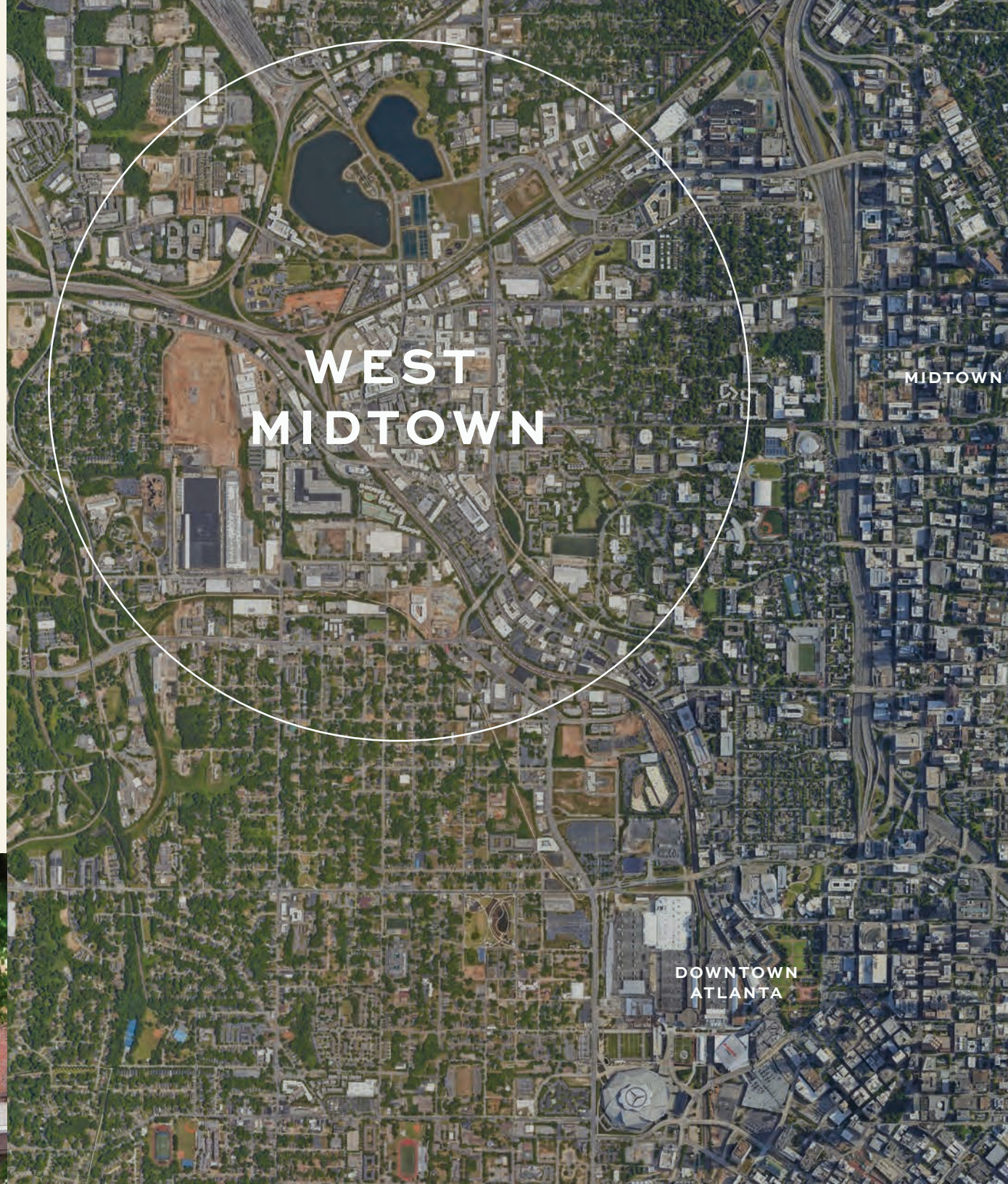

# AREA MAP

WESTSIDE  
RESERVOIR  
PARK

WEST  
BOYD

PALO SANTO

TAQUERIA del SOL

THE INTERLOCH  
Puttshack

barcelona

WEST EGG  
café

upbeet

KING FLOW  
CENTER  
TERMINAL  
WEST  
AT KING  
FLOW

STOCKYARDS  
DUC

SLIM + HUSKY'S  
PIZZA

Nattie's  
CHICKEN

887  
W. MARIETTA ST.

MILLER + UNION

Snooze  
AN A.M. EATERY

The  
OPTIMIST

BASTONE!



Emmy SQUARED  
PIZZA

bartaco



WESTSIDE BELTLINE  
CONNECTOR

# FLOOR PLAN

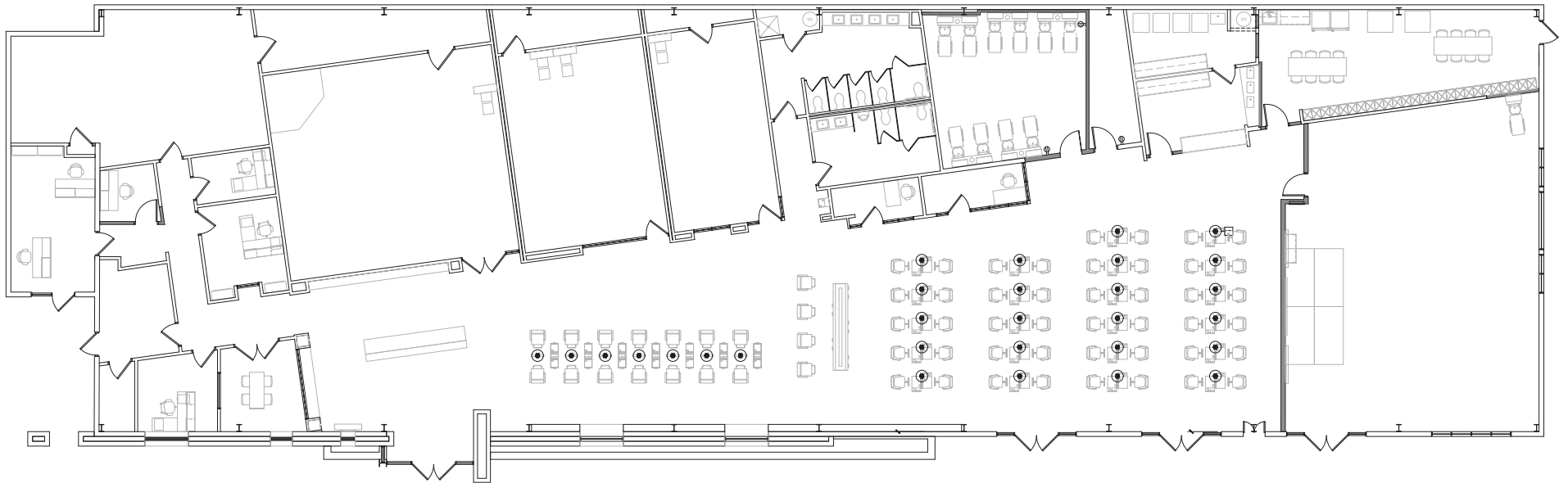

# ADDITIONAL PHOTOS



# ABOUT KING PLOW

**KING PLOW ARTS CENTER** began as an antiquated plow factory, but has been transformed into an arts community and center for commercial, performing and visual arts. In 1990, the owners designed a plan to build affordable live/work studios, commercial artist spaces, art galleries, areas designed for the performing arts, and a restaurant within the buildings while preserving their historic and architectural significance.

King Plow consists of sixteen buildings, on 12.5 acres with approximately 256,000 square feet including common hallways.

The King Plow Arts Center has a diversified mix of creative tenants and condominium owners representing fine, commercial and performing arts. Tenants representing fine art areas include: photographers, sculptors, painters, and metal smiths. The commercial arts are represented by a floral sculptor, architectural firms, interior designers, a modeling agency, graphic design firms, advertising agencies, multi-media designers, and several product & fashion photographers.

In 2003, King Plow Arts Center became the first Historic live/work/loft/office/commercial condominium in the city. The arts center now consists of live/work studios, commercial office spaces, special event facilities, Actor's Express Theater, Bold American Food Co. catering, Paul Mitchell hair school, and Terminal West concert venue. King Plow is the largest center of its kind in the city and has become a significant part of Atlanta's arts community.

King Plow Arts Center is pleased to serve as a model of adaptive reuse of historic structures and as a catalyst for the proposed Marietta Street Arts Corridor.

